

Manufactured primarily of anodized aluminum and stainless steel. This nozzle is designed to deliver a flat screen of water to form a protective curtain. Ball bearing female inlet swivel. Available in 1.5" or 2.5"

Flow Pattern

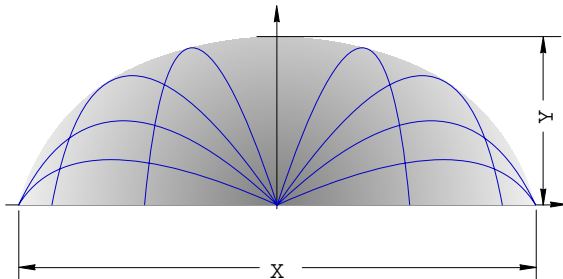

Flow 500 l/min / 135 GPM: X=26 m / 85 ft, Y=7 m / 23 ft
 Flow 1200 l/min / 320 GPM: X=32 m / 105 ft, Y=10 m / 32 ft

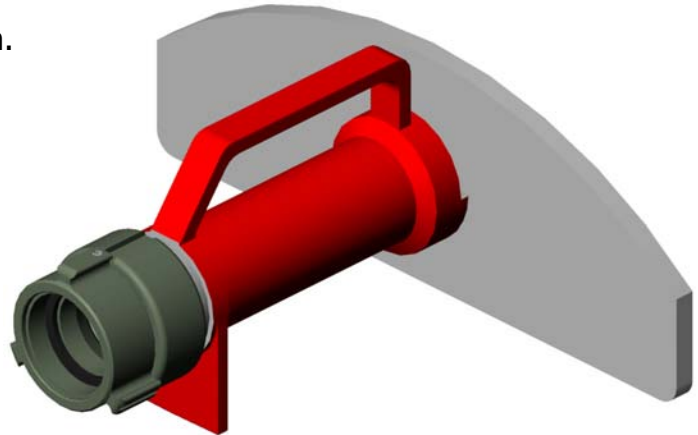

Code	Description	H	W	L	Weight	FLOW	
						GPM	LPM
2238	Waterwall 1.5" inlet	5.3"	12.5"	9.2"	3.5 lb	135	500
2239	Waterwall 2.5" inlet	6.5"	15.8"	12.5"	6.8 lb	320	1200

DMA Nozzles Straight Stream, Fog and Shutoff Model DHT is for Electric Fire

Description	Aluminum	Bronze
	Code	Code
DMA - 40/12-12 - 1.5" inlet	7330	7681
DMA - 40/14-14 - 1.5" inlet	1929	7683
DMA - 65/18-15 - 2.5" inlet	7331	
DHT - 40 (electric fire) - 1.5" inlet	7332	
DHT - 40/12-12 - 1.5" inlet		7682
DHT - 65 (electric fire) - 2.5" inlet	7333	



DMB "Poket" Nozzles Flat and Straight Stream and Shutoff

Description	Aluminum	Bronze
	Code	Code
DMB - 20/7-7 - 1.0" inlet	7350	7360
DMB - 40/12-12 - 1.5" inlet	2784	2837
DMB - 40/14-14 - 1.5" inlet	7351	7361
DMB - 65/18-15 - 2.5" inlet	7352	7362

